

Mac OS X Setup

Note Ensure that you are running OS X version 10.8 or later with an Intel processor, and that you have **Administrator Privileges**. Also ensure that all antivirus and firewall programs are disabled during installation.

1 Turn on the headset. The blue LED will turn on. **You can pair the device at anytime.**

2 Proceed with pairing procedure.

For **Mac OS X 10.8:**

- | | | |
|---|--|--|
| a Open System Preferences | b Click Bluetooth icon | c Click on the “+” icon |
| d If asked to “Select Device Type” choose Any Device | e Click Passkey Options . Set to “Use a specific passkey” | f Select MindWave Mobile and click Next |
| g Enter 0000 if prompted for passkey | h Use the Default setting if asked about services | i Click Close to complete pairing |

For **Mac OS X 10.9 ~ 10.13:**

- | | | |
|---|--------------------------------------|--|
| a Open System Preferences | b Click Bluetooth icon | c Select MindWave Mobile |
| d Click Pair to complete pairing (Ensure that your Bluetooth is turned on) | | |

**The pairing will show as “Connected” for a few seconds, and then change itself back to “Not Connected”. Don’t worry, whenever you start a MindWave Mobile 2 app, it will show as “Connected” again.*

3 Once the headset is paired, visit **MWM2.neurosky.com**. QR code on page one.

4 Follow the instructions on that page to download, install and run the **“MindWave Mobile Tutorial”** app. Then follow instructions from the app to further configure your headset.

5 You may now download other brainwave-powered apps from the NeuroSky App Store, **store.neurosky.com/collections/apps**

iOS Setup

1 Turn on the headset. The **blue LED** will turn on.

2 Visit **MWM2.neurosky.com**. You can use the QR code on the first page of this guide to easily navigate there.

3 Follow the instructions on that page to download, install and run the **“MindWave Mobile Tutorial”** app, then follow instructions from the app to further configure your headset.

4 Go to the NeuroSky Store at **http://store.neurosky.com/collections/apps/ios** to download apps. **Read app descriptions to ensure they are compatible with MindWave Mobile 2 and your operating system.*

Quick Start Guide

mindwave
MOBILE 2

IMPORTANT
You must properly set up each
MindWave Mobile 2 by going to this address:

MWM2.neurosky.com



MindWave Mobile 2 Headset Basics

How to Wear the MindWave Mobile 2 Headset
The headset should rest on the head as shown with the sensor tip touching the forehead, the ear loop behind the ear and the clip attached.

The Headset

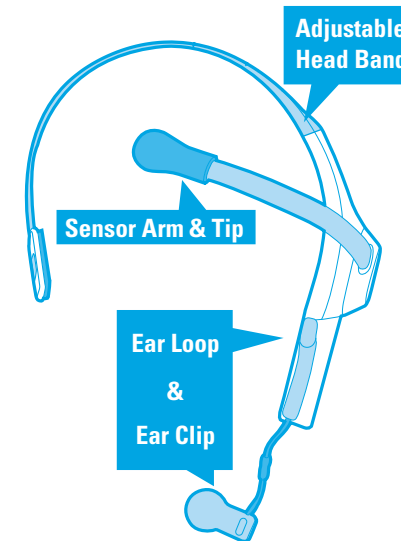

Brainwave Sensor Placement

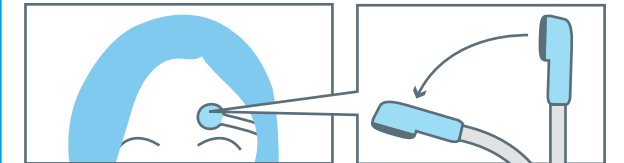

The sensor tip should touch the skin above your left eyebrow with a little pressure.
Bend the arm before putting on headset for best fit.

Check these areas to get the best fit

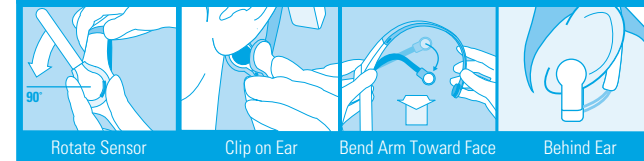

Before You Start

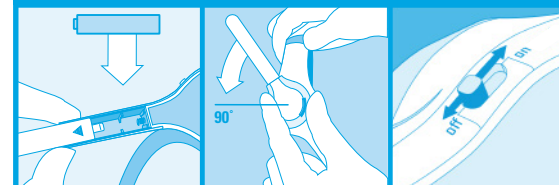

Insert One (1) AAA Battery
Rotate the Sensor Arm Down
Power Located Here



Headset will be **OFF**
The LED will be **OFF**



LED

Headset will be **ON**
When the headset is powered on the LED will **light up blue**.

You can pair the headset at any time while it is powered on.

Signal Status & Meters

Signal Status To operate the MindWave Mobile 2 with your device you will need to achieve *Bluetooth* pairing with the device first and also get a good signal with the MindWave Mobile 2. These icons show the status of your connection in the upper right hand corner of most NeuroSky apps.



Quick Fixes & Older Icons If your device is properly paired and there is a fresh battery in the headset, try these tips to help ensure a good connection. Older applications may use the signal status icons below.

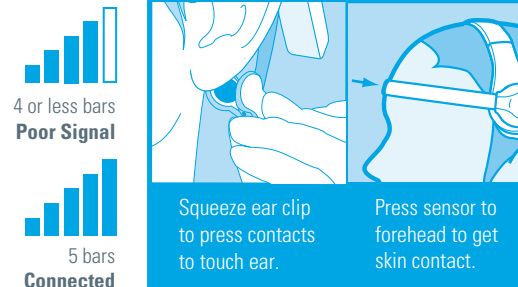

eSense Meters The meters are gauges of certain mental states that the MindWave Mobile 2 can detect. You can try to control them to cause action in an app, or the app can react to how you happen to be feeling in the moment.



Attention / Focus

- Identify and maintain a single thought
- Stare at a specific object
- Focus on something you like
- Calculate math
- Listen intently to someone talking



Meditation / Relaxation

- Take a deep breath and slowly exhale
- Deliberately relax all muscles
- Clear mind of any specific thoughts
- Let mind wander and drift
- Close eyes



Blink

- Blink eyes as naturally as possible
- You may need to blink harder or softer to control certain things



LED Light - The MindWave Mobile 2 LED light has two colors: Red and Blue. Refer to the chart to see what state the headset is in.

Light	Headset State	Meaning
Off	Powered Off	Headset is turned off or has no battery
Solid Red	Low Battery	Headset needs a new battery
Solid Blue	Powered On	Headset is turned on



Travel Note for ALL PLATFORMS *MindWave Mobile 2 is sensitive to different electrical standards in other countries. If you travel to another country, use **MindWave Mobile Tutorial** to reconfigure.*

Windows Setup

- 1 Turn on the headset. The blue LED will turn on. **You can pair the device at anytime.**
- 2 For **WINDOWS 10:**
 - a Click **Settings**
 - b Click **Devices**
 - c Click **Bluetooth**
 - d Select **MindWave Mobile**. Click **Pair**. **If you see multiple devices named MindWave Mobile, select the option with a headset icon.**  
 - e If it requires a pass key, please enter **0000**
- For **WINDOWS 8 & 8.1:**
 - a Click **Settings, Control Panel** then
 - b Click **Add Device**
 - c Select **MindWave Mobile** and click **Next**
 - d It may take several minutes to install necessary files on your system
 - e If it requires a pass key, please enter **0000**
- For **WINDOWS 7:**
 - a Click **Start**, then **Control Panel**
 - b Click **Add Device**
 - c Select **MindWave Mobile** click **Next**
 - d Click **Close** to complete pairing
 - e If it requires a pass key, please enter **0000**
- 3 Once the headset is paired, visit **MWM2.neurosky.com**. QR code on page one.
- 4 Follow the instructions on that page to download, install and run the "**MindWave Mobile Tutorial**" app. Then follow instructions from the app to further configure your headset.
- 5 You may now download other brainwave-powered apps from the NeuroSky App Store, **store.neurosky.com/collections/apps**

Android Setup

- 1 Turn on the headset. The blue LED will turn on. **You can pair the device at anytime.**
- 2 Refer to your Android *Bluetooth*™ pairing procedure. Select "**MindWave Mobile**" device when it appears. Enter "**0000**" as the *Bluetooth*™ authentication key if prompted.
- 3 Once the headset is paired, visit **MWM2.neurosky.com**. You can use the QR code on the first page of this guide to easily navigate there.
- 4 Follow the instructions on that page to download, install and run the "**MindWave Mobile Tutorial**" app, then follow instructions from the app to further configure your headset.
- 5 Use your Android Market or Google Play to search for the words "**NeuroSky**" or "**MindWave Mobile**" to find additional apps you can use with your headset!